

**theben****Antenna top2 RC-GPS**

for top2 RC devices

9070610



310336 03

**Designated use**

GPS receivers enable global positioning. As every satellite continually transmits UTC time (Greenwich Mean Time) via an atomic clock, it can be received worldwide.

The top2 RC GPS antenna receives position and time signals from GPS satellites and passes them on to time switches. The exact local time is calculated in the time switch according to the set time zone.

**Adjust/open top2 RC GPS antenna**

- Position the top2 RC GPS so that it has a "clear view" of the sky. The yellow LED lights up (receiver is ready).

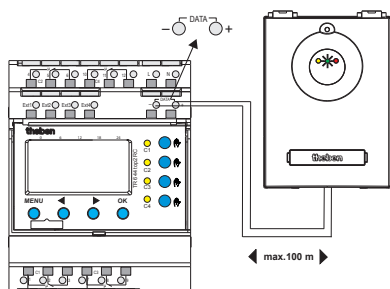
**Install top2 RC GPS antenna**

- Fix top2 RC GPS to the wall (using drilling template).

The top2 RC GPS antenna can also be attached to a mast (using hose clips).

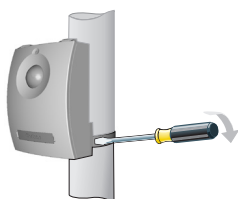

Good reception is achieved by installing on external wall of buildings.



- Do not lay cable parallel to antenna.
- Lay cable separately.
- Avoid installing under roofs.
- Connect at least one 365 day time switch or time switches such as LUNA, SELEKTA (+ top2 GPS power unit) to top2 RC GPS antenna .
- Connect a maximum of five 365 day time switches.

Antenna function only possible if the connected time switch supplied with operating voltage.

**Connect top2 RC GPS antenna****Connect cable**

- Strip cable by 8 mm (max. 9 mm).
- Insert cable at 45° in the open terminal (2 cables per terminal position possible).
- Only with flexible wires: To open the plug-in screwless terminal, press screwdriver downwards.

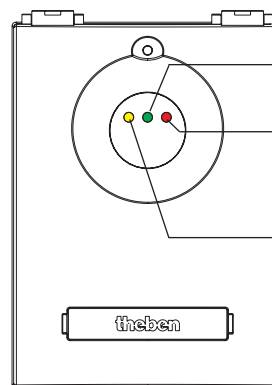
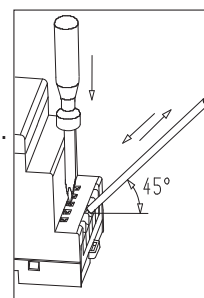

**green** LED flashes: GPS reception available

**red** LED lights up: 2-wire cable to time switch is not connected correctly

**yellow** LED flashes: too few time switches connected

**yellow** LED lights up: Receiver ready but no GPS data received as yet

- Ensure correct polarity.

**Technical data**

- Operating voltage: Bus voltage: 15 V DC
- Permissible ambient temperature: -30 °C ... +70 °C
- Protection class: II in accordance with EN 60730-1
- Protection rating: IP 55 in accordance with EN 60529
- Cable types: NYM (3 x 1.5 mm<sup>2</sup>), J-Y(St)Y (2 x 2 x 0.8 mm<sup>2</sup>), KNX bus line YCYM
- Use: only for devices in top2 RC range
- Power requirement: 70 mA (at DATA Bus)
- Pollution level: 3 in accordance with EN 60730-1
- Rated impulse withstand voltage: 330 V
- Mode of operation : Type 1
- Connection cross section: AWG 14-20

**Connection examples:**

1. Minimum number of participants that are needed to operate the antenna:
  - 1 x 365 day time switch TR 64x top2 RC with 100 mA feed or
  - 2 x weekly time switches TR 611 top2 RC, SELEKTA 171 top2 RC, LUNA 121-122 top2 RC each with 50 mA feed or
  - 1 x weekly time switch with 50 mA feed plus 1 x top2 GPS (907 0 892) power unit with 50 mA feed
2. Maximum number of participants at DATA bus as the maximum power at DATA bus is limited to 500 mA
  - 5 x 365 day time switches TR 64x top2 RC each with 100 mA feed
  - ...

**Service address**

**Theben AG**  
Hohenbergstr. 32  
72401 Haigerloch  
GERMANY  
Telephone +49 7474 692-0  
Fax +49 7474 692-150

**Hotline**

Telephone +49 7474 692-369  
Fax +49 7474 692-207  
hotline@theben.de  
**Addresses, telephone numbers etc.**  
**www.theben.de**